

July 22, 1991
RainerVista.91-2

Introduced by: GREG NICKELS

Proposed No.: 91 - 609

ORDINANCE NO. **10125**

1 AN ORDINANCE relating to the annexation of
2 an area known as 91-2 to Rainier Vista
3 Sewer District for sewer service.

4 STATEMENT OF FACT:

5 1. A notice of intention proposing the annexation of an
6 area known as 91-2 to Rainier Sewer District for sewer service,
7 was filed with the county council effective July 22, 1991.

8 2. Rainier Sewer District has found the petition for
9 annexation to be sufficient and has, by Resolution 604
10 concurred with the proposed annexation for sewer service.

11 3. Rainier Vista Sewer District filed a Declaration of
12 Non-significant Impact dated March 29, 1991, on the proposed
13 annexation for sewer service.

14 4. The county council held a public hearing on the 26th
15 day of August, 1991, and has considered the
16 criteria set forth in R.C.W. 56.02.060.

17 BE IT ORDAINED BY THE COUNCIL OF KING COUNTY:

18 SECTION 1. The annexation by Rainier Vista Sewer District
19 for sewer service, of the area known as 91-2 for annexation and
20 described in Section 4 herein is approved. This proposed
21 annexation is consistent with R.C.W. 56.02.060 as described in
22 the attached King County Council Annexation Report on Rainier
23 Vista 91-2.

24 SECTION 2. Rainier Vista Sewer District for sewer service,
25 is the appropriate entity to serve the area proposed to be
26 annexed.

27 SECTION 3. Completion of this annexation does not
28 constitute county approval or disapproval of any other permits,
29 certifications, or actions necessary to provide sewer service
30 to this annexation area.

1 SECTION 4. The area known as 91-2 to be annexed for sewer
2 service is described as follows:

3 All that portion of the West half of the Southeast quarter
4 of Section 9, Township 23 North, Range 4 East, W.M.
5 described as follows:

6 Beginning at the intersection of the centerline of Military
7 Road South with the Easterly production of the South line
8 of Mabell Addition according to the Plat thereof found in
9 Volume 38 of Plats, Page 3, Records of King County,
10 Washington;

11 Thence West along the South line thereof to the centerline
12 of 24th Avenue South;

13 Thence South along said centerline to the centerline of
14 South 128th Street, which is the South line of said West
15 half;

16 Thence East along said South line to the centerline of
17 Military Road South;

18 Thence Northwesterly along said centerline to the Point of
19 Beginning.

20 INTRODUCED AND READ for the first time this 29th day

21 of July 1991.

22 PASSED this 7th day of October, 1991.

23 KING COUNTY COUNCIL
24 KING COUNTY, WASHINGTON

25 Lois North
26 Chair

27 ATTEST:

28 Janet Masno
29 DEPUTY Clerk of the Council

30 APPROVED this 17th day of October, 1991.

31 Paul S. ...
32 King County Executive

FILED
21 JUL 16 2011
PLANNING DEPARTMENT

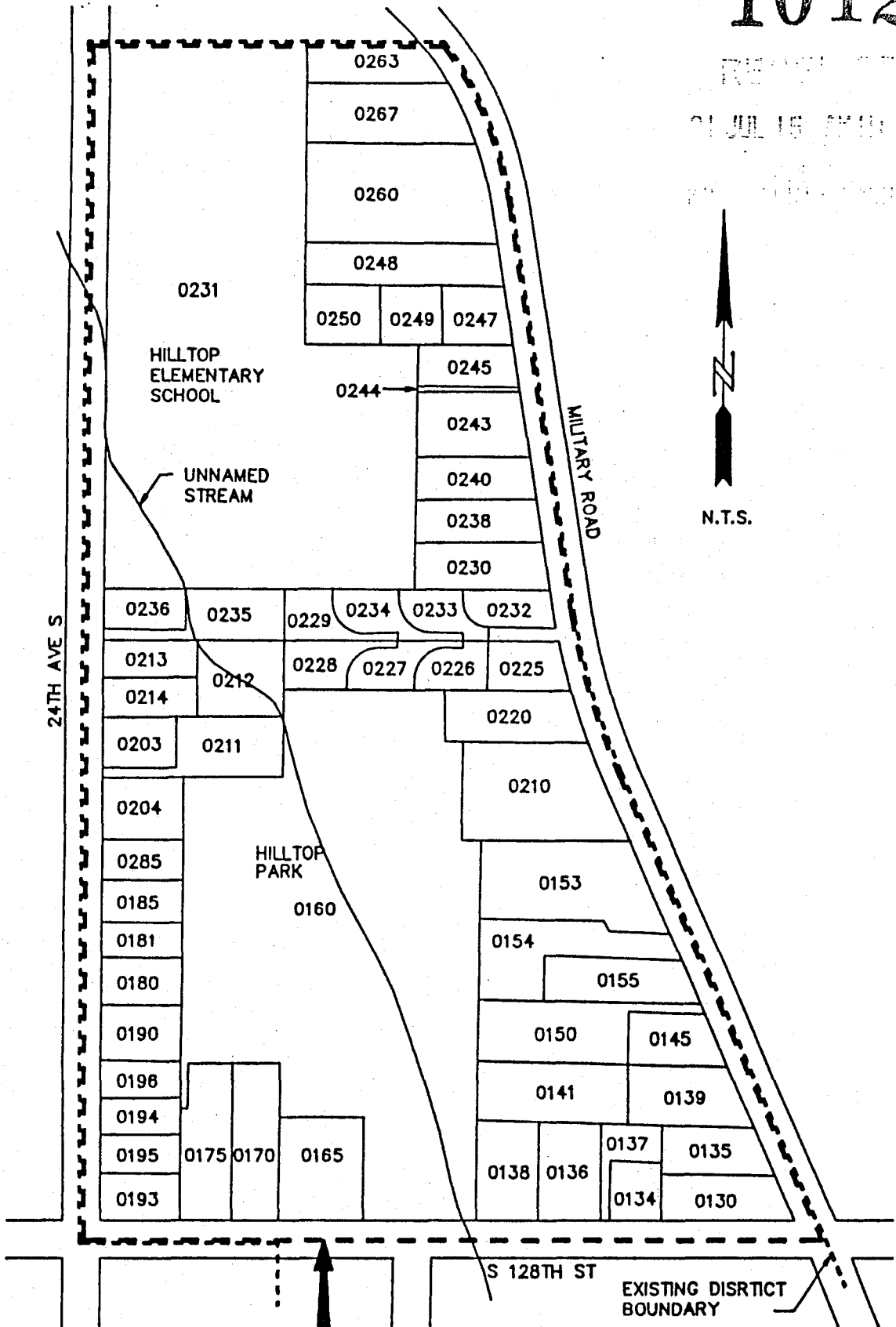

PROPOSED ANNEXATION 91-2
 TO
RAINIER VISTA SEWER DISTRICT
 36.5 ACRES

ANEX90-2

EXHIBIT E